

APPENDIX A



STATUTORY CONSULTATION ON PARKING CONTROLS IN YOUR AREA

West Harrow, Honeybun Estate and Whitmore School area

PUBLIC CONSULTATION

IMPORTANT – THIS AFFECTS YOU – PLEASE READ

Area Parking Consultation

What is this about?

A public consultation was conducted in July 2011 on the review of the Controlled Parking Zones (CPZ) and waiting and loading restrictions within the West Harrow area. A separate public consultation about parking issues in the Whitmore School and Honeybun Estate areas was carried out in September 2010. We would like to take this opportunity to thank all those that responded to these consultations.

The results of these public consultations were presented to the Traffic and Road Safety Advisory Panel (TARSAP) meeting on 20 September 2011. TARSAP were asked to approve the recommendations made in the report to take the scheme forward to Statutory Consultation. The recommendations were based on the responses from the residents in the two consultations.

Officers took a consistent approach to the consultation responses when considering recommendations to TARSAP. This meant that officers only recommended changes where there was a majority of support for such, from the residents and businesses in that section of road.

The report was presented to the Portfolio Holder for Environment and Community Safety for his final approval. The recommendations, TARSAP report, survey results and the approved minutes of the meeting can be viewed on the Harrow Council website at -

<http://tinyurl.com/blatb59>

The link will need to be entered into your web browser. If you do not have personal access to the internet the council public libraries do have internet access that residents may use. Alternatively hard copies can be provided on request. The recommendations are also summarised below for your convenience.

The Portfolio Holder agreed the recommendations to take the scheme to the next stage, which is Statutory Consultation. Statutory Consultation is the legal process that the council is required to undertake before any changes can be made to any waiting or loading restrictions, or designated parking bays on the public highway.

Summary of recommendations, which can be viewed in association with the enclosed plans.

- Bouverie Road - the section between Vaughan Road and the existing CPZ W - be included within CPZ W, with the exception of properties numbered 2-10 and 1-19;
- Butler Road - the western extremity be removed from the existing CPZ W;
- Drury Road (Vaughan Road to Sumner Road) - be included within the existing CPZ W;
- Heath Road - be included within the existing CPZ W;
- Sandhurst Avenue - a new Monday to Friday 10-11am and 2-3pm CPZ be created;
- Vaughan Road between the two existing CPZs - be included as part of CPZ W;
- Vaughan Road near its junction with Bouverie Road - install a time limited loading bay and 5 Pay and Display parking bays to assist local businesses in the area, both to be operational Monday to Saturday 8am – 6.30pm;
- Unnamed link road between Vaughan Road and Butler Avenue – change the existing Pay and Display (P&D)/shared business permit parking bays to be shared use P&D/ Business/Resident permit holders;

- Bessborough Road (Roxborough Avenue to Whitmore Road) - be included within the existing CPZ E;
- Honeybun Estate south (Charles Crescent, Pool Road, Wood Close, Farmborough Close) - a new Monday to Saturday 10-11am and 2-3pm CPZ be created;
- Lascelles Avenue – be included in the new CPZ for Honeybun Estate south to prevent displaced parking causing potential access issues on this Restricted Borough Distributor Road;
- Merton Road, Ferring Close and that section Porlock Avenue between the two roads - a new Monday to Friday 10-11am and 2-3pm and Saturday and Sunday 10-11am CPZ be created;
- Treve Avenue – be included in the new CPZ for Whitmore Road to prevent displaced parking causing potential access issues on this Restricted Borough Distributor Road;
- Whitmore Road (Bessborough Road to Shaftesbury Avenue) - a new Monday to Friday 10-11am CPZ be created;
- Marshall Close – south side, remove the waiting restrictions from the shoulders of the parking lay-by;
- Vaughan Road near Bowen Road - shorten the existing permit bay away from the junction and replace with a short section of waiting restrictions in response to concerns raised by the Police;
- CPZ W – an additional afternoon Monday to Friday 2-3pm control period be introduced along side the existing Monday to Friday 10-11am control period.
- Double yellow lines will be installed at junctions bends and narrowings on safety grounds to reinforce the well established rules in the Highway Code.

The results of the Statutory Consultation be presented to a future Traffic and Road Safety Advisory Panel meeting.

What happens next?

As mentioned earlier this is the Statutory Consultation stage, which is the legal requirement that the council needs to complete. The plans have been developed taking into account, where practical, all the comments we received during the previous consultation stages.

This is your opportunity to review the plans in private and make any further comments. It will not be possible to add any further amendments now, as the scheme has been developed using previous resident and business comments. However, small changes that do not impact on the safety for the wider community may still be possible.

We shall advertise the Traffic Management Order by placing notices on street lamp columns and in a local paper on or about 16 February 2012 which will also explain where the plans can be seen, this would give anyone a chance to comment or place a formal objection if they wish to do so by 7 March 2012.

The results and any formal objections will be presented to TARSAP for consideration to proceed to implementation on the agreed measures. It is anticipated that the results will be reported to TARSAP on 20 June 2012. If there are any formal objections then TARSAP will determine what action needs to be taken for the elements of the scheme to be progressed. Once approval to proceed has been obtained the scheme will be given to our contractors to implement and all residents will be informed of the outcome.

Making a formal statutory objection

Under the legislation which controls the statutory consultation process anyone can make a comment or formal objection to the proposals. However the objection needs to be made in **writing (email is acceptable)** including the word **object** or **objection** (to distinguish it clearly from comments) and the **reason** for the basis of the objection with your name and address. The law sets out a strict timetable for considering formal objections.

Please return your comments by 7 March 2012. You can submit your comments on-line by visiting www.harrow.gov.uk/trafficconsultations which will direct you to a page containing the survey name West Harrow Statutory Consultation.

Written objections to the scheme proposals should be sent to:

Traffic and Highway Network Manager
Harrow Council
PO Box 39
Civic Centre
Harrow HA1 2XA

Or by email to transportation@harrow.gov.uk

Quoting ref DP 2011-20 and making sure it is received by 7 March 2012.

More information

If you have any further questions, or wish to comment, please contact the project engineer:

Andrew Leitch
Tel: 020 8424 1888
Email: transportation@harrow.gov.uk

Or write to: Traffic and Highway Network Manager
Harrow Council
P.O. Box 39
Civic Centre
Harrow, HA1 2XA

STATUTORY CONSULTATION IN WEST HARROW, HONEYBUN ESTATE AND WHITMORE SCHOOL AREAS.

REVIEW OF PARKING CONTROLS QUESTIONNAIRE

Please complete this questionnaire.

Please return your comments by **7 March 2012**. In an effort for the council to be more energy and cost effective, you can submit your questionnaire on-line by visiting **www.harrow.gov.uk/consultations** and then clicking to visit live consultations. This will direct you to a page containing the **West Harrow Statutory Consultation**. You may be asked to register your details before completing the survey.

Alternatively you may still complete this hard copy and return it using the enclosed prepaid reply envelope (no stamp required), to arrive by **7 March 2012**.

Questionnaires returned without a name and address will not be officially recorded in the results. We count your household/business as one response.

First Name..... Family Name.....

Business Name (if applicable).....

Property Number/Name..... Street Name.....

Postcode..... Date.....

Please tick as appropriate (If you disagree you must also write in formally to object as detailed in the accompanying leaflet as a 'No' response here will not be treated as a formal objection to the proposals)

Q1 Do you agree with the proposals developed for your section of road or area?

Yes

No

Don't know / No opinion

Please Note: The double yellow lines are required on safety grounds for emergency vehicle access and reinforce the well established rules of the Highway Code (Rule 243, Revised 2007 Edition). It may be possible to make minor amendments if community safety is not compromised.

Thank you for taking the time to complete this questionnaire.

ANY OTHER COMMENTS

Please use this space to provide any further comments you have about the existing Controlled Parking Zone or any comments to support your answers to the questionnaire.

Unfortunately it is not practical to reply to each individual response, however all comments will be noted and reported to the Traffic and Road Safety Advisory Panel.

If you **DO NOT** want your response to be available for public inspection please tick here.

NOTE: All questionnaire responses and comments will be available in full for the private viewing by the Ward Councillors and the Portfolio Holder for Environment and Community Safety so they will be able to confirm all the comments made by individuals if required.

Please call the number below for a large print version of this document, or a summary of this document in your language.

Albanian Nëqoftëse gjuha Angleze nuk është gjuha juaj e parë, dhe keni nevojë për përkthimin e informatave të përmbajtura në këtë dokumentë, ju lutemi kontaktoni numërin dhënë.

Arabic إذا كانت الانجليزية ليست لغتك الاولى وتحتاج لترجمة معلومات هذه الوثيقة، الرجاء الاتصال على رقم

Bengali যদি ইংরেজি আপনার মাতৃভাষা না হয় এবং আপনি যদি এই প্রচারপত্রের তথ্যগুলোর অনুবাদ পেতে চান তাহলে যে টেলিফোন নম্বর দেওয়া আছে সেখানে দয়া করে যোগাযোগ করুন।

Chinese 如果你主要說用的語言不是英語而需要將這份文件的內容翻譯成中文，請打註明的電話號碼提出這個要求。

Farsi اگر انگلیسی زبان اول شما نیست و شما نیاز به ترجمه اطلاعات موجود در این مدرک را دارید، لطفاً با شماره داده شده تماس بگیرید.

Gujarati જો ઈંગ્લિશ તમારી પ્રથમ ભાષા ન હોય અને આ દસ્તાવેજમાં રહેલ માહિતીનો તરજૂમો (ટ્રાન્સલેશન) તમને જોઈતો હોય તો કૃપા કરી જણાવેલ નંબર ઉપર ફોન કરો.

Hindi यदि आपको अंग्रेजी समझ नहीं आती और आपको इस दस्तावेज़ में दी गई जानकारी का अनुवाद हिन्दी में चाहिए तो कृपया दिए गए नंबर पर फोन करें।

Panjabi ਜੇ ਤੁਹਾਨੂੰ ਅੰਗਰੇਜ਼ੀ ਸਮਝ ਨਹੀਂ ਆਉਂਦੀ ਤੇ ਤੁਹਾਨੂੰ ਇਸ ਦਸਤਾਵੇਜ਼ ਵਿਚ ਦਿੱਤੀ ਗਈ ਜਾਣਕਾਰੀ ਦਾ ਤਰਜਮਾ ਪੰਜਾਬੀ ਵਿਚ ਚਾਹੀਦਾ ਹੈ ਤਾਂ ਕਿਰਪਾ ਕਰਕੇ ਦਿੱਤੇ ਗਏ ਨੰਬਰ ਤੇ ਫੋਨ ਕਰੋ।

Somali Haddii Ingiriisku uusan ahayn afkaaga koowaad aadna u baahan tahay turjumidda xog ku jirta dokumentigan fadlan la xiriir lambarka lagu siiyey.

Tamil ஆங்கிலம் உங்கள் தாய்மொழியாக இல்லாதிருந்து இப்பத்திரத்திலிருக்கும் தகவலின் மொழிபெயர்ப்பு உங்களுக்கு தேவைப்பட்டால் தயவுசெய்து தரப்பட்ட தொலைபேசி எண்ணில் தொடர்பு கொள்ளவும்.

Urdu اگر انگریزی آپ کی مادری زبان نہیں ہے اور آپ کو اس دستاویز میں دی گئی معلومات کا اردو ترجمہ درکار ہے، تو براہ کرم دیئے گئے نمبر پر رابطہ کریں۔

020 8424 1677

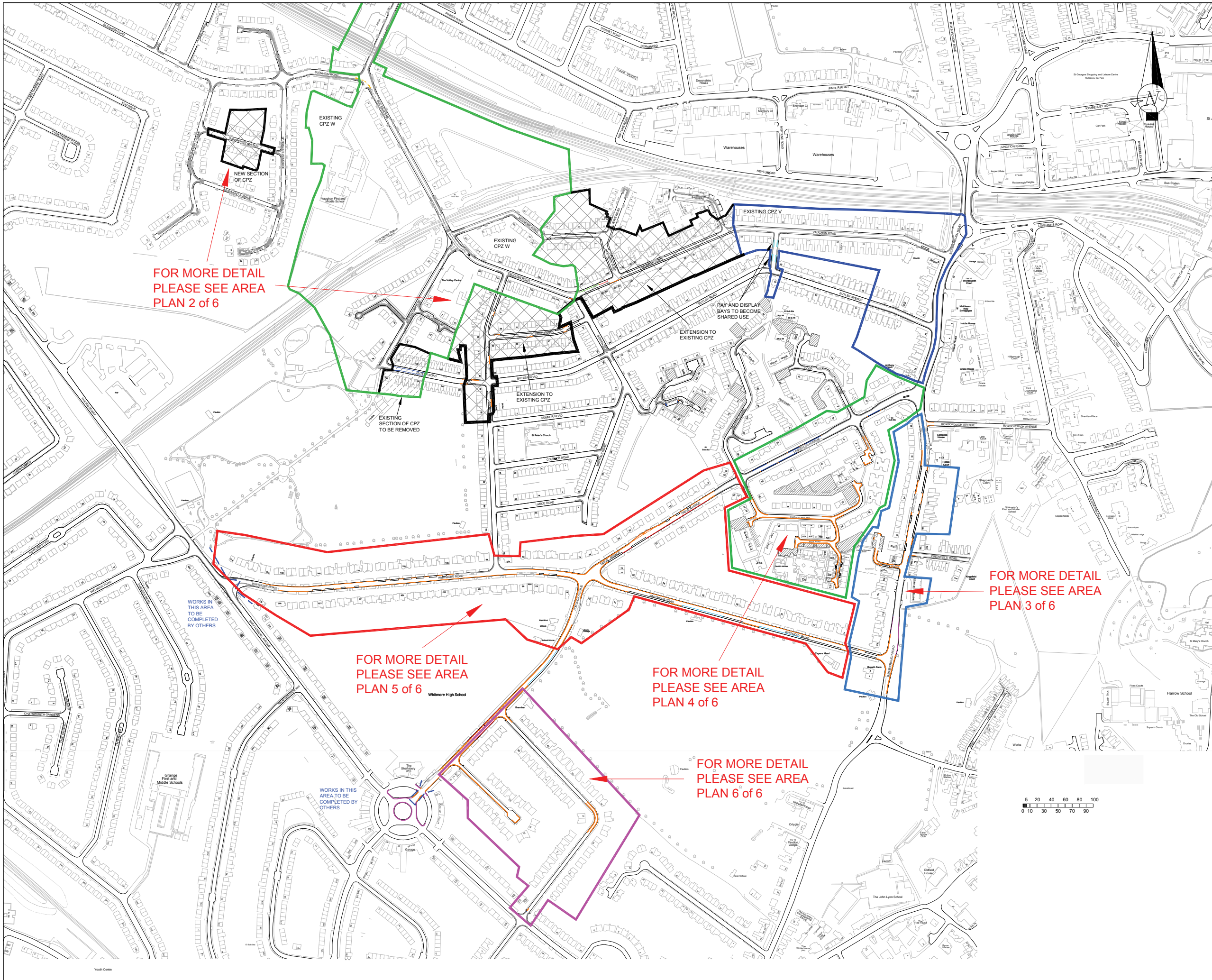

- NOTES:**
- EXISTING WEST HARROW CPZ V
 - EXISTING WEST HARROW CPZ W
 - PROPOSED EXTENSIONS OF CPZ
 - PROPOSED DELETION OF WEST HARROW CPZ W
 - PROPOSED BESSBOROUGH ROAD AREA TO JOIN EXISTING CPZ E
Mon-Sat 8.30am-6.30pm
 - PROPOSED NEW HONEYBUN ESTATE SOUTH CPZ (INCLUDING LASCELLES AVENUE)
Mon-Sat 10-11am & 2-3pm
 - PROPOSED NEW WHITMORE ROAD CPZ (INCLUDING TREVE AVENUE)
Mon-Fri 10-11am
 - PROPOSED NEW MERTON ROAD AND FERRING CLOSE CPZ (INCLUDING PORLOCK AVENUE)
Mon-Fri 10-11am & 2-3pm and Sat-Sun 10-11am

FOR MORE DETAILED PLANS SEE INDIVIDUAL AREA PLANS 2 TO 6

This map is reproduced from or based upon Ordnance Survey material with the permission of Ordnance Survey on behalf of the Controller of Her Majesty's Stationery Office (© Crown copyright. Unauthorised reproduction without Crown Copyright and may lead to prosecution or civil proceedings. London Borough of Harrow 10079204)

HarrowCOUNCIL
LONDON

COMMUNITY & ENVIRONMENT TRANSPORTATION P.O. Box 39, Civic Centre, Harrow, Middlesex. HA1 2XA
Tel: 020 8863 5611 Fax: 020 8420 9611

A	ORIGINAL	23/1/12	AJL
---	----------	---------	-----

Designation: WEST HARROW, HONEYBUN ESTATE AND WHITMORE SCHOOL AREA PARKING CONTROLS

Title: STATUTORY CONSULTATION PLANS OVERVIEW PLAN (1 of 6)

Scale: N.T.S. @ A1	Drawn: AJL Date: 23/01/2012	Checked: PN
-----------------------	--------------------------------	-------------

Drawing no: T/DWG/000267

Autocad file: O:\TRAFFIC_PARKING AND SUSTAINABLE TRANSPORT TEAM\CPZ\West Harrow-Bessborough Road\16 month review\Statutory Consultation 2012\Drawings\Stat Consult dwg 2012.dwg

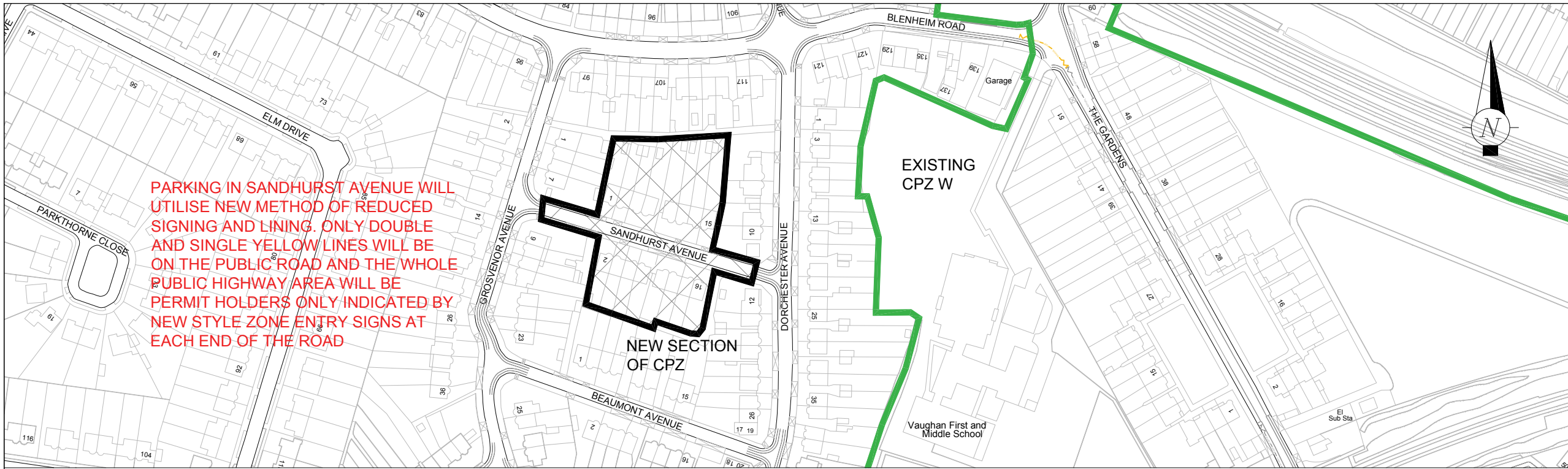

PARKING IN SANDHURST AVENUE WILL UTILISE NEW METHOD OF REDUCED SIGNING AND LINING. ONLY DOUBLE AND SINGLE YELLOW LINES WILL BE ON THE PUBLIC ROAD AND THE WHOLE PUBLIC HIGHWAY AREA WILL BE PERMIT HOLDERS ONLY INDICATED BY NEW STYLE ZONE ENTRY SIGNS AT EACH END OF THE ROAD

- NOTES:**
- PROPOSED PERMIT PARKING BAY
 - PROPOSED FREE PARKING BAY
 - PROPOSED PAY AND DISPLAY PARKING BAY
 - PROPOSED LOADING BAY
 - PROPOSED SHARED USE PARKING BAY AVAILABLE TO BE USED BY PAY AND DISPLAY-BUSINESS PERMIT-RESIDENT PERMIT FOR ZONE V
 - PROPOSED REMOVAL OF EXISTING ROAD MARKINGS
 - PROPOSED DOUBLE YELLOW LINE
 - PROPOSED SINGLE YELLOW LINE - ZONE TIME
 - LOCATION OF SMALL ALTERATION TO YELLOW LINES
 - EXISTING WEST HARROW CPZ W
 - PROPOSED EXTENSION OF WEST HARROW CPZ W
 - PROPOSED DELETION OF WEST HARROW CPZ W
 - EXISTING WEST HARROW CPZ V

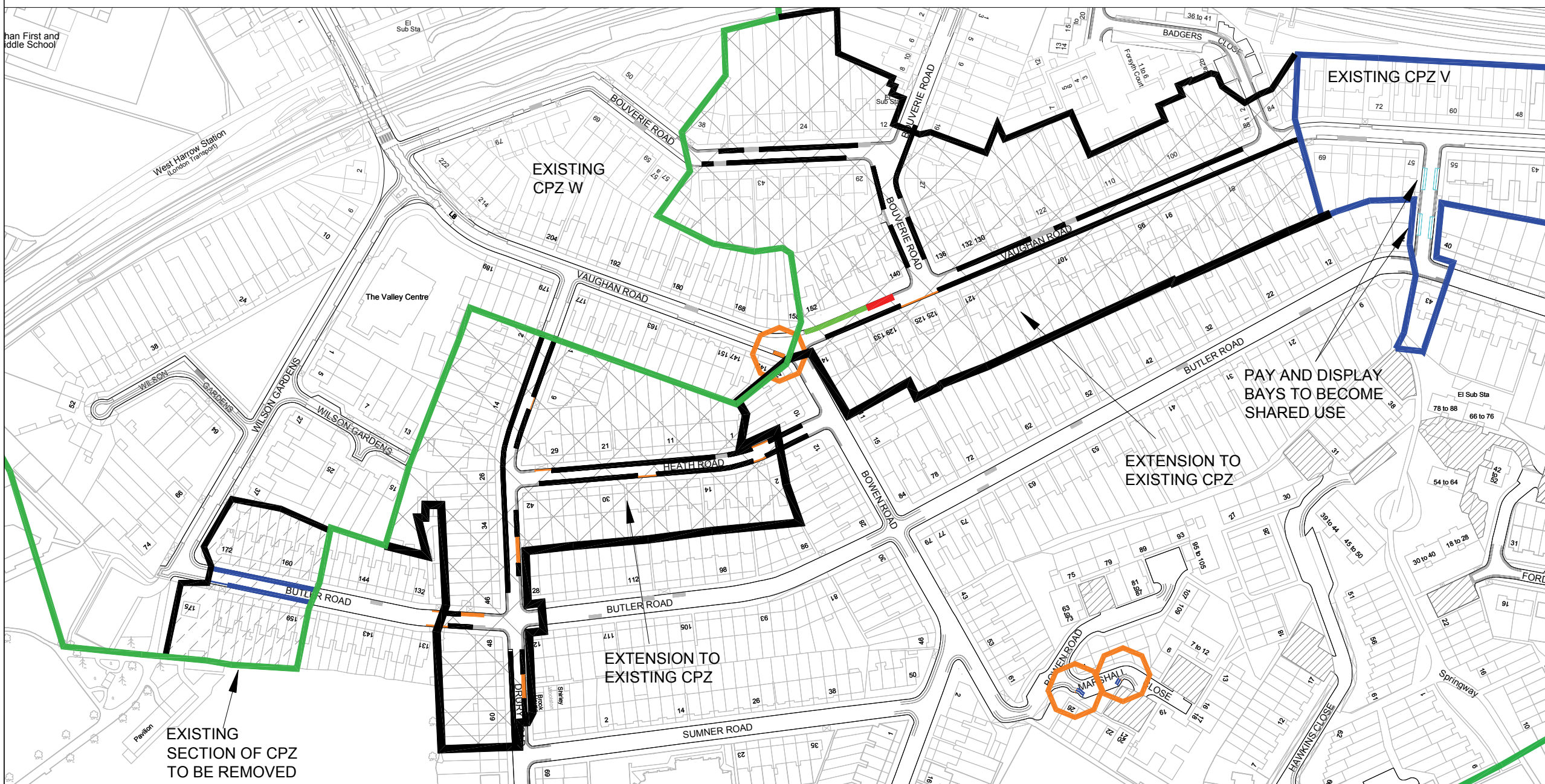

EXISTING SECTION OF CPZ TO BE REMOVED

PAY AND DISPLAY BAYS TO BECOME SHARED USE

EXTENSION TO EXISTING CPZ

EXTENSION TO EXISTING CPZ

Harrow COUNCIL
LONDON

COMMUNITY & ENVIRONMENT TRANSPORTATION P.O. Box 39, Civic Centre, Harrow, Middlesex. HA1 2XA
Tel: 020 8863 5611 Fax: 020 8420 9611

A	ORIGINAL	23/1/12	AJL
---	----------	---------	-----

Designation Details of Revision

Project	Date	Sign
WEST HARROW, HONEYBUN ESTATE AND WHITMORE SCHOOL AREA PARKING CONTROLS		

Title: STATUTORY CONSULTATION PLANS WEST HARROW AREA (2 of 6)

Scale: 1:1000 @ A1	Drawn: AJL	Checked: PN
Drawing no: T/DWG/000267	Date: 23/01/2012	

Autocad file: O:\TRAFFIC_PARKING AND SUSTAINABLE TRANSPORT TEAM\CPZ\West Harrow-Bessborough Road\16 month review\Statutory Consultation 2012\Drawings\Stat Consult.dwg 2012.dwg

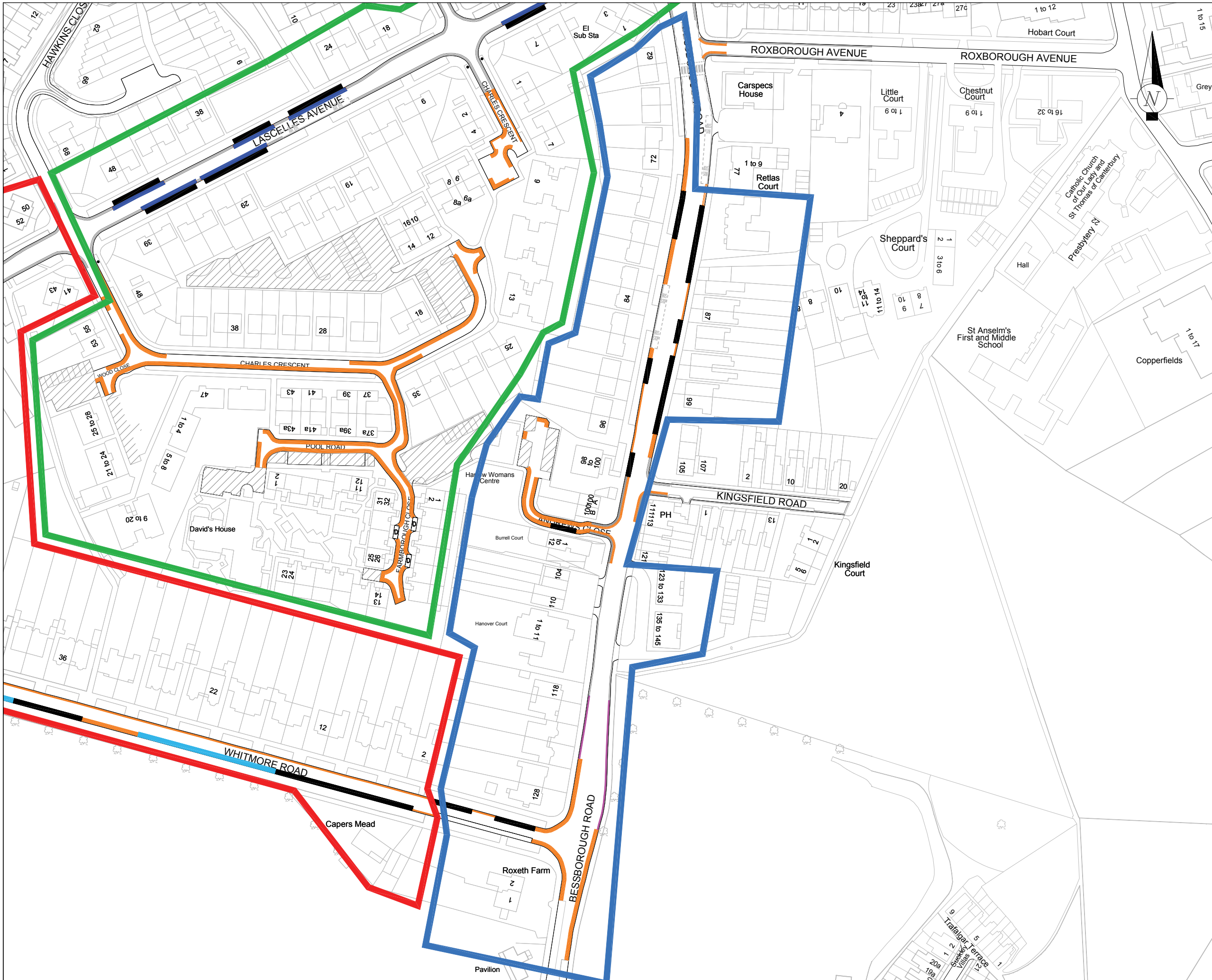

- NOTES:**
- PROPOSED PERMIT PARKING BAY
 - PROPOSED FREE PARKING BAY
 - PROPOSED DISABLED PARKING BAY
 - PROPOSED REMOVAL OF EXISTING ROAD MARKINGS
 - PROPOSED DOUBLE YELLOW LINE
 - PROPOSED SINGLE YELLOW LINE - ZONE TIME
 - PROPOSED SINGLE YELLOW LINE - MONDAY TO SATURDAY 8am - 6.30pm
 - PROPOSED SINGLE YELLOW LINE - ANY DAY 7am - 7pm
 - PRIVATE ROAD OR PARKING AREA
 - EXISTING WEST HARROW CPZ V
 - PROPOSED BESSBOROUGH ROAD AREA TO JOIN EXISTING CPZ E Mon-Sat 8.30am-6.30pm
 - PROPOSED NEW HONEYBUN ESTATE SOUTH CPZ (INCLUDING LASCELLES AVENUE) Mon-Sat 10-11am & 2-3pm
 - PROPOSED NEW WHITMORE ROAD CPZ (INCLUDING TREVE AVENUE) Mon-Fri 10-11am

This map is reproduced from or based upon Ordnance Survey material with the permission of Ordnance Survey on behalf of the Controller of the Harrow's Stationery Office (© Crown copyright. Unauthorised reproduction infringes Crown Copyright and may lead to prosecution or civil proceedings, London Borough of Harrow 10007925).

Harrow COUNCIL
LONDON

COMMUNITY & ENVIRONMENT
TRANSPORTATION

P.O. Box 39, Civic Centre,
Harrow, Middlesex. HA1 2XA
Tel: 020 8863 5611
Fax: 020 8420 9611

A	ORIGINAL	23/1/12	AJL
---	----------	---------	-----

Designation Details of Revision Date Sign

Project **WEST HARROW, HONEYBUN ESTATE AND WHITMORE SCHOOL AREA PARKING CONTROLS**

Title **STATUTORY CONSULTATION PLANS BESSBOROUGH ROAD AREA (3 of 6)**

Scale N.T.S. @ A1	Drawn AJL	Checked PN
Date 23/01/2012		

Drawing no **T/DWG/000267**

Autocad file
O:\TRAFFIC_PARKING AND SUSTAINABLE TRANSPORT TEAM\CPZ\
West Harrow-Bessborough Road\16 month review\Statutory Consultation 2012\
Drawings\Stat Consult.dwg 2012.dwg

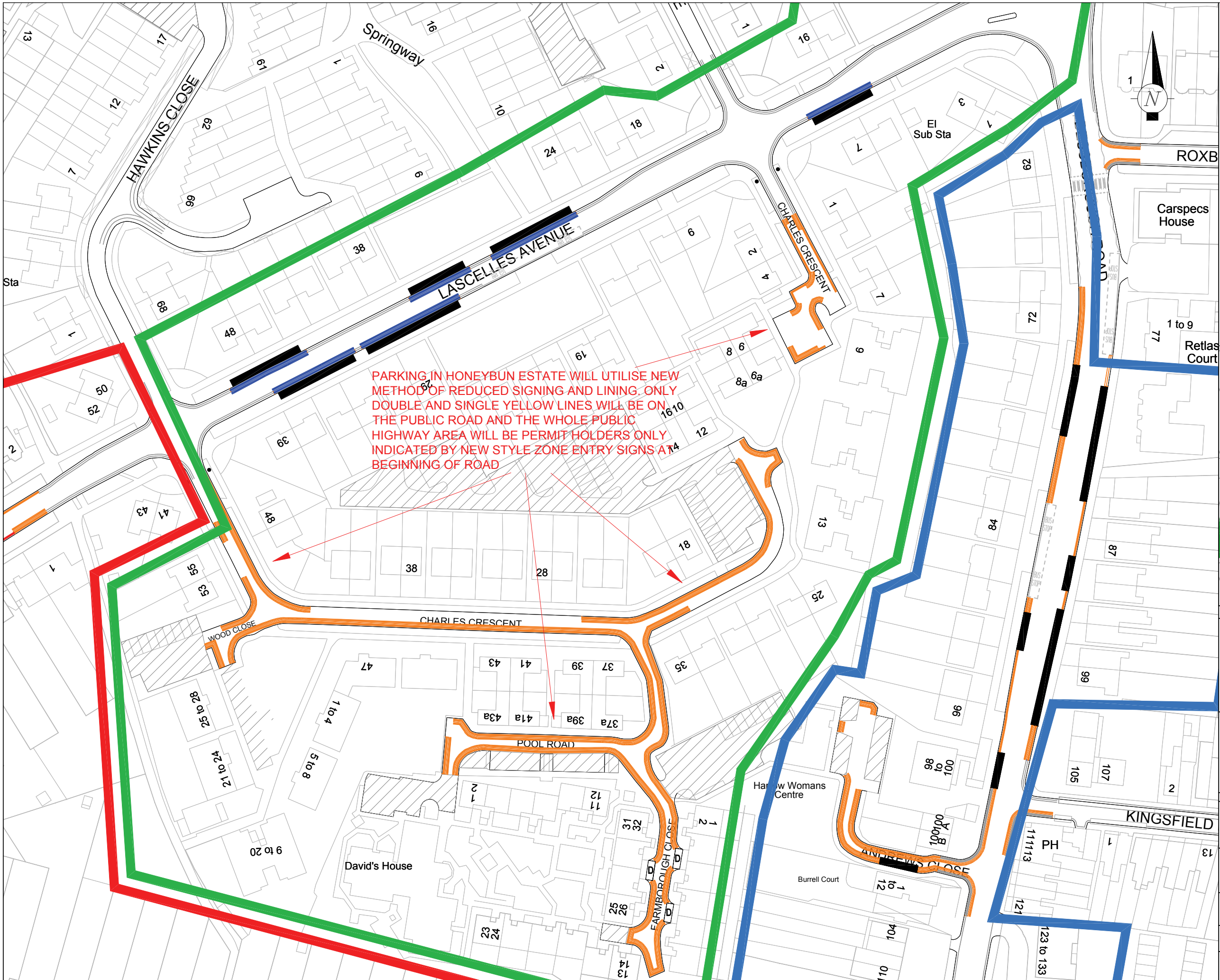

PARKING IN HONEYBUN ESTATE WILL UTILISE NEW METHOD OF REDUCED SIGNING AND LINING. ONLY DOUBLE AND SINGLE YELLOW LINES WILL BE ON THE PUBLIC ROAD AND THE WHOLE PUBLIC HIGHWAY AREA WILL BE PERMIT HOLDERS ONLY INDICATED BY NEW STYLE ZONE ENTRY SIGNS AT BEGINNING OF ROAD

- NOTES:**
- PROPOSED PERMIT PARKING BAY
 - PROPOSED FREE PARKING BAY
 - PROPOSED DISABLED PARKING BAY
 - PROPOSED REMOVAL OF EXISTING ROAD MARKINGS
 - PROPOSED DOUBLE YELLOW LINE
 - PROPOSED SINGLE YELLOW LINE - ZONE TIME
 - PROPOSED SINGLE YELLOW LINE - ANY DAY 7am - 7pm
 - PRIVATE ROAD OR PARKING AREA
 - EXISTING WEST HARROW CPZ V
 - PROPOSED BESSBOROUGH ROAD AREA TO JOIN EXISTING CPZ E Mon-Sat 8.30am-6.30pm
 - PROPOSED NEW HONEYBUN ESTATE SOUTH CPZ (INCLUDING LASCELLES AVENUE) Mon-Sat 10-11am & 2-3pm
 - PROPOSED NEW WHITMORE ROAD CPZ (INCLUDING TREVE AVENUE) Mon-Fri 10-11am

Harrow COUNCIL
LONDON







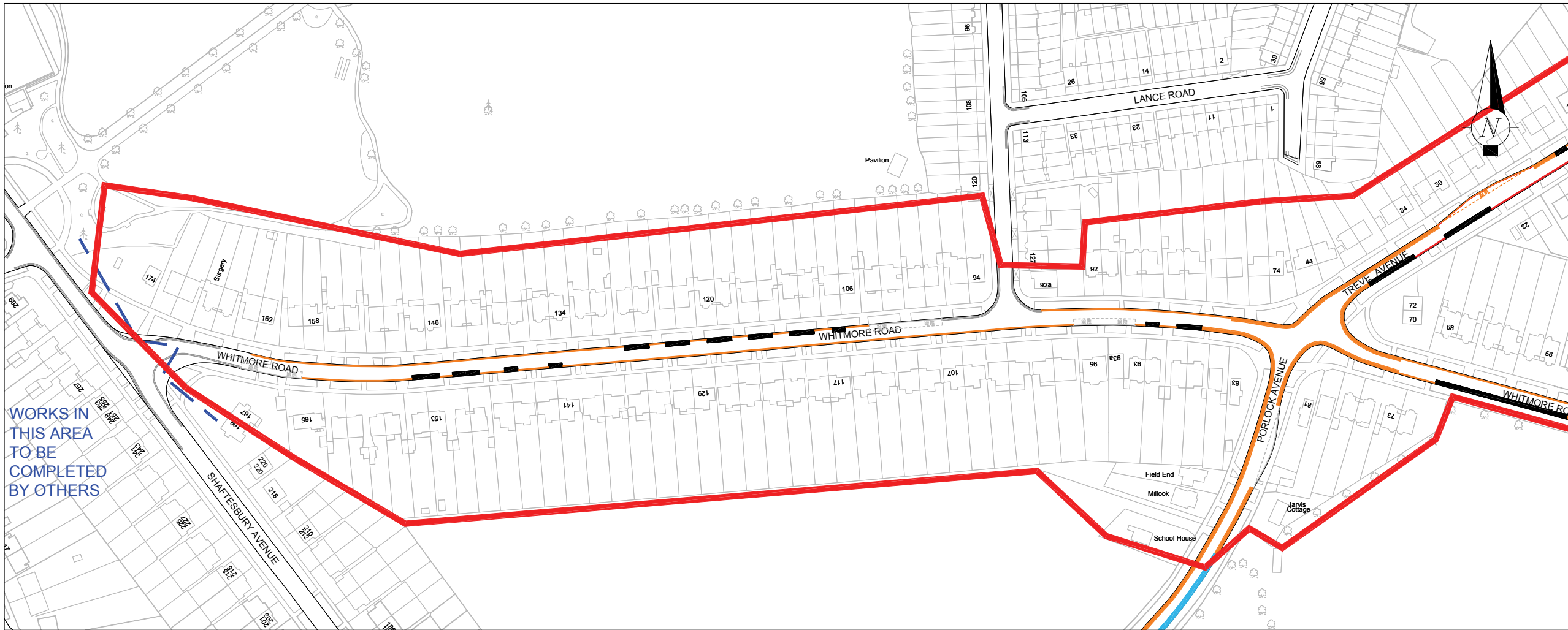





COMMUNITY & ENVIRONMENT
TRANSPORTATION

P.O. Box 39, Civic Centre,
Harrow, Middlesex, HA1 2XA
Tel: 020 8863 5611
Fax: 020 8420 9611

A	ORIGINAL	23/1/12	AJL
Designation Details of Revision			
Project		Date	
Project		Sign	
WEST HARROW, HONEYBUN ESTATE AND WHITMORE SCHOOL AREA PARKING CONTROLS			
Title			
STATUTORY CONSULTATION PLANS HONEYBUN ESTATE (SOUTH) AREA (4 of 6)			
Scale	Drawn	Checked	
1:500	AJL	PN	
© A1	Date	Date	
	23/01/2012		
Drawing no			
T/DWG/000267			
Autocad file			
O:\TRAFFIC_PARKING AND SUSTAINABLE TRANSPORT TEAM\CPZ\West Harrow-Bessborough Road\16 month review\Statutory Consultation 2012\Drawings\Stat Consult.dwg 2012.dwg			



WORKS IN THIS AREA TO BE COMPLETED BY OTHERS

- NOTES:**
-  PROPOSED PERMIT PARKING BAY
 -  PROPOSED FREE PARKING BAY
 -  PROPOSED DISABLED PARKING BAY
 -  PROPOSED REMOVAL OF EXISTING ROAD MARKINGS
 -  PROPOSED DOUBLE YELLOW LINE
 -  PROPOSED SINGLE YELLOW LINE - ZONE TIME
 -  PROPOSED SINGLE YELLOW LINE - MONDAY TO SATURDAY 8am - 6.30pm
 -  PROPOSED SINGLE YELLOW LINE - ANY DAY 7am - 7pm
 -  PRIVATE ROAD OR PARKING AREA
 -  PROPOSED BESSBOROUGH ROAD AREA TO JOIN EXISTING CPZ E Mon-Sat 8.30am-6.30pm
 -  PROPOSED NEW HONEYBUN ESTATE SOUTH CPZ (INCLUDING LASCELLES AVENUE) Mon-Sat 10-11am & 2-3pm
 -  PROPOSED NEW WHITMORE ROAD CPZ (INCLUDING TREVE AVENUE) Mon-Fri 10-11am

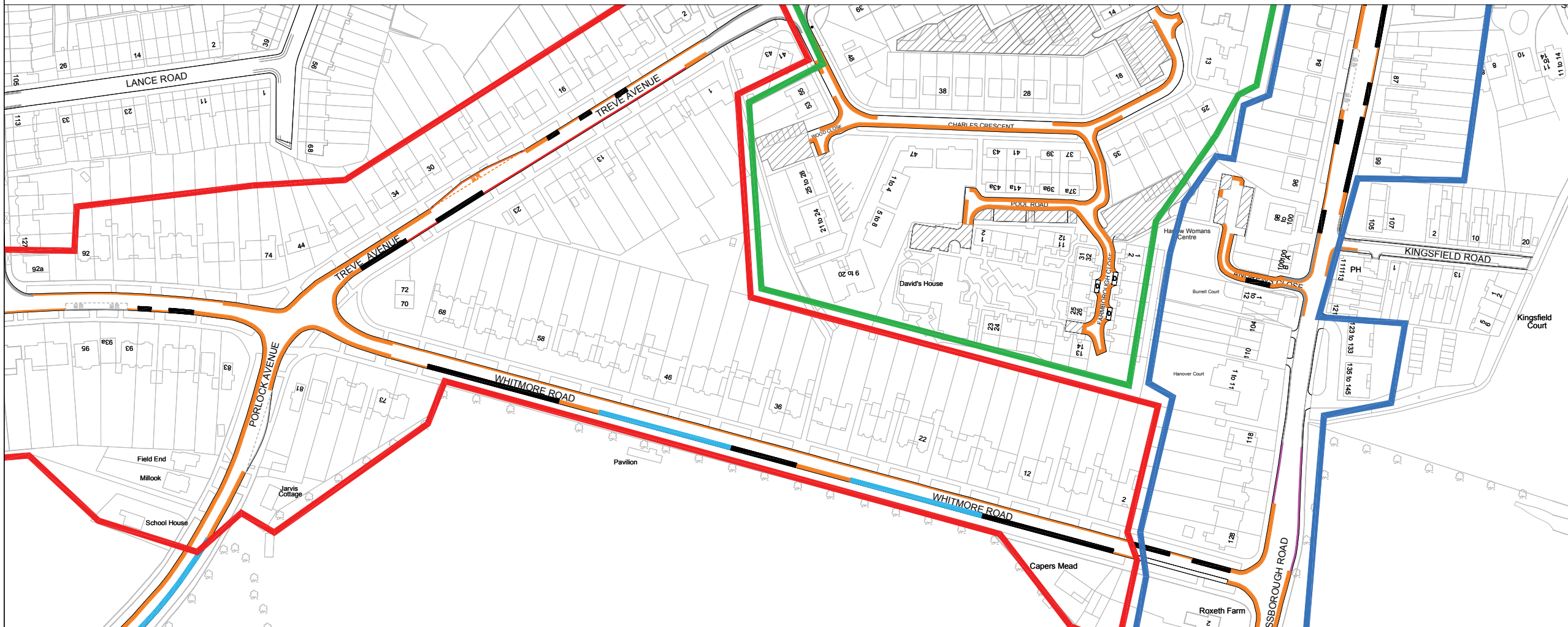

This map is reproduced from or based upon Ordnance Survey material with the permission of Ordnance Survey on behalf of the Controller of the Harrow's Stationery Office (© Crown copyright. Unauthorised reproduction infringes Crown Copyright and may lead to prosecution or civil proceedings, London Borough of Harrow 100079254)

Harrow COUNCIL
LONDON

COMMUNITY & ENVIRONMENT
TRANSPORTATION

P.O. Box 39, Civic Centre,
Harrow, Middlesex. HA1 2XA
Tel: 020 8863 5611
Fax: 020 8420 9611



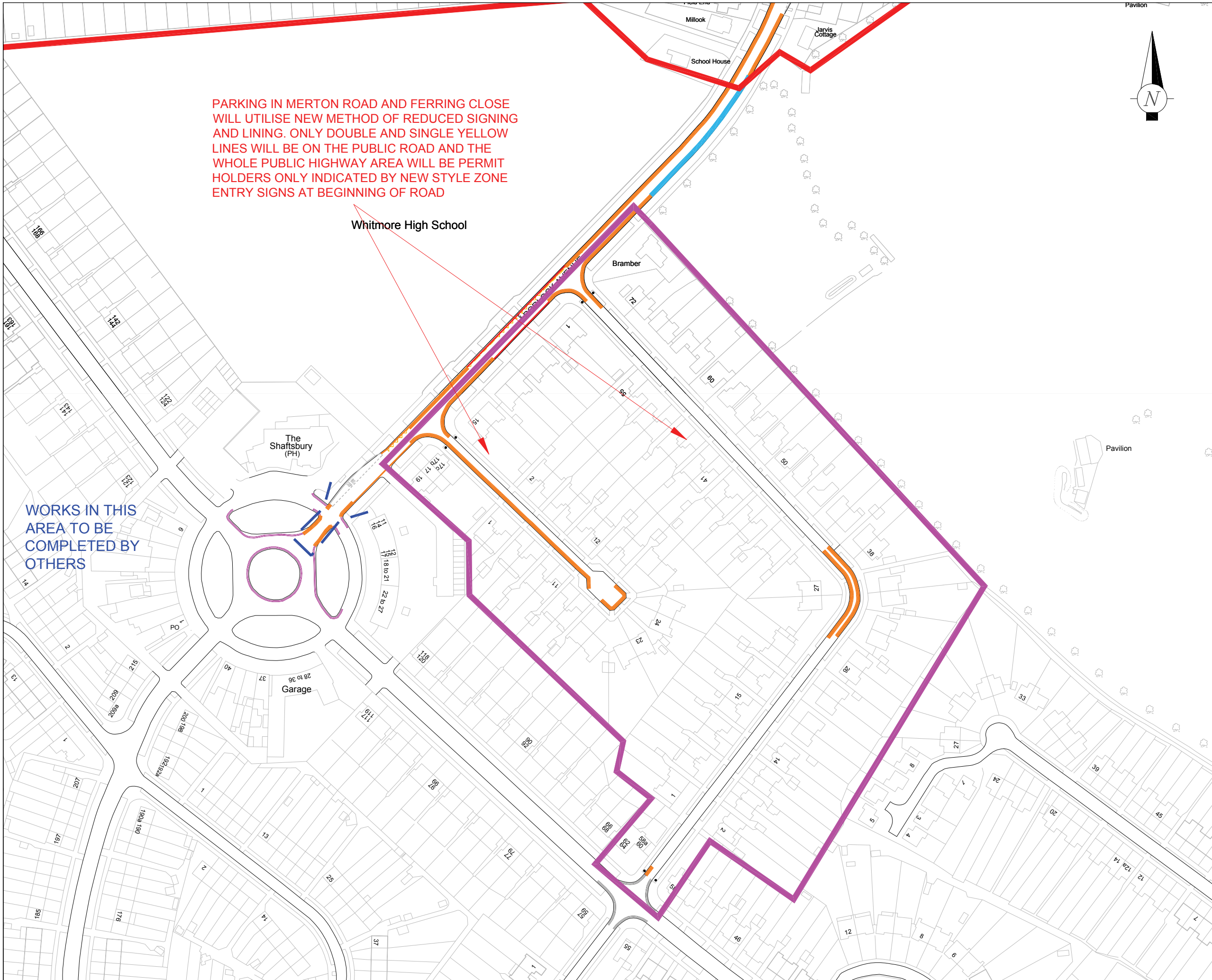



A	ORIGINAL	23/1/12	AJL
Designation		Details of Revision	
Project		Date	
Project		Sign	
<p>WEST HARROW, HONEYBUN ESTATE AND WHITMORE SCHOOL AREA PARKING CONTROLS</p> <p>STATUTORY CONSULTATION PLANS</p> <p>WHITMORE ROAD AREA (5 of 6)</p>			
Scale	Drawn	Checked	
1:1000	AJL	PN	
@ A1	Date	Date	
	23/01/2012		
Drawing no			
T/DWG/000267			
Autocad file			
O:\TRAFFIC_PARKING AND SUSTAINABLE TRANSPORT TEAM\CPZ\West Harrow-Bessborough Road\16 month review\Statutory Consultation 2012\Drawings\Stat Consult.dwg 2012.dwg			



PARKING IN MERTON ROAD AND FERRING CLOSE WILL UTILISE NEW METHOD OF REDUCED SIGNING AND LINING. ONLY DOUBLE AND SINGLE YELLOW LINES WILL BE ON THE PUBLIC ROAD AND THE WHOLE PUBLIC HIGHWAY AREA WILL BE PERMIT HOLDERS ONLY INDICATED BY NEW STYLE ZONE ENTRY SIGNS AT BEGINNING OF ROAD

Whitmore High School

WORKS IN THIS AREA TO BE COMPLETED BY OTHERS

- NOTES:**
-  PROPOSED PERMIT PARKING BAY
 -  PROPOSED FREE PARKING BAY
 -  PROPOSED DOUBLE YELLOW LINE
 -  PROPOSED SINGLE YELLOW LINE - ZONE TIME
 -  PROPOSED SINGLE YELLOW LINE - ANY DAY 7am - 7pm
 -  PROPOSED NEW WHITMORE ROAD CPZ (INCLUDING TREVE AVENUE) Mon-Fri 10-11am
 -  PROPOSED NEW MERTON ROAD AND FERRING CLOSE CPZ (INCLUDING PORLOCK AVENUE) Mon-Fri 10-11am & 2-3pm and Sat-Sun 10-11am

Harrow COUNCIL
LONDON

COMMUNITY & ENVIRONMENT
TRANSPORTATION

P.O. Box 39, Civic Centre,
Harrow, Middlesex. HA1 2XA
Tel: 020 8863 5611
Fax: 020 8420 9611

A	ORIGINAL	23/1/12	AJL
---	----------	---------	-----

Designation Details of Revision

Project **WEST HARROW, HONEYBUN ESTATE AND WHITMORE SCHOOL AREA PARKING CONTROLS**

Title **STATUTORY CONSULTATION PLANS WHITMORE SCHOOL AREA (6 of 6)**

Scale	Drawn	Checked
N.T.S. @ A1	AJL	PN
	Date	
	23/01/2012	

Drawing no T/DWG/000267

Autocad file
O:\TRAFFIC_PARKING AND SUSTAINABLE TRANSPORT TEAM\CPZ\West Harrow-Bessborough Road\16 month review\Statutory Consultation 2012\Drawings\Stat Consult.dwg 2012.dwg